

# HORIZONTAL LEVEL SWITCHES TYPE PML/FML

Rev.01/2019

## STANDARD DATA SHEET

Small size.  
Economical and reliable.  
Executions in Polypropylene and PVDF  
Operating ambient temperature -30 / +55 °C - 90% RH.  
Easy and quick installation.  
Degree of protection IP65.



S1.FML.GC-Z



S1.FML.20C



S1.PML.GC-Z



S1.PML.15N

## TECHNICAL DATA

Tab.1

| Type | Material      |       | Float<br>S.G. | Pressure<br>Bar | Temperature<br>°C |
|------|---------------|-------|---------------|-----------------|-------------------|
| PML  | Polypropylene | Blue  | 0,6           | 3               | 90                |
| FML  | PVDF          | Black | 0,75          | 6               | 130               |

## PROCESS CONNECTIONS

Tab.2

| Assembly from inside the tank  | Assembly from outside the tank and available threads                       |                            |                            |
|--|--|----------------------------|----------------------------|
| <b>16K</b><br>Standard body thread M16 x 1,5<br>Installation see Tab.4 | <b>GC-</b><br>Viton standard compression gasket.<br>Installation see Tab.4 | <b>15</b><br>1/2"<br>C - N | <b>20</b><br>3/4"<br>C - N |

### Male thread

| C               | N           |
|-----------------|-------------|
| Conical UNI 7/1 | Conical NPT |
| 15 - 20         |             |

### Available materials

| O       | S        | P             | F    |
|---------|----------|---------------|------|
| Brass   | AISI-316 | Polypropylene | PVDF |
| 15 - 20 |          | 16K           |      |

### Gasket

| Viton    | Z | Silicon    | W |
|----------|---|------------|---|
| Standard |   | On request |   |
| 16K - GC |   |            |   |

## ELECTRICAL CONTACT

Tab.3

| TYPE |      | POWER |    | VOLTAGE |     | CURRENT |     |
|------|------|-------|----|---------|-----|---------|-----|
|      |      | VA    | W  | AC      | DC  | AC      | DC  |
| 3D   | SPST | 70    | 50 | 300     | 350 | 0,5     | 0,7 |
| 7D   | SPDT | 20    | 20 | 150     | 150 | 0,5     | 0,5 |

### Wiring

|    |            |     |                         |
|----|------------|-----|-------------------------|
| C1 | 1,5m cable | C   | Cable length on request |
| C2 | 3m cable   | FST | Male faston 2 x 0,8     |

## DIMENSIONS

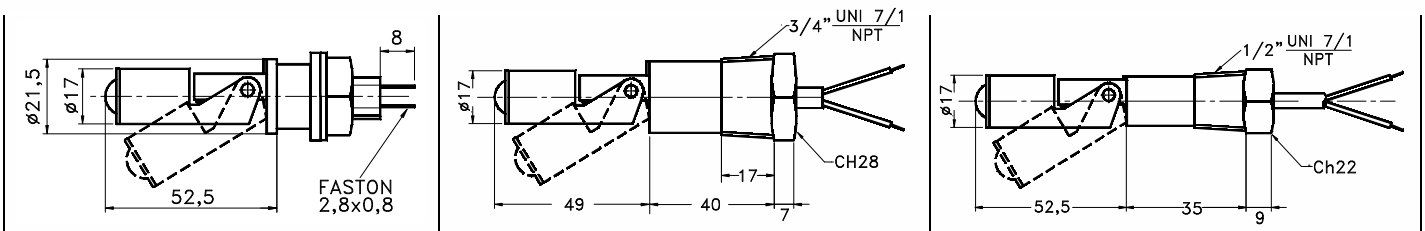

N.B. Faston wiring is available only on 16K - GC version.

